

# BENCHES

Designer: JPE Design Studio



## SLAT OPTIONS

- Oiled hardwood
- Composite

## FRAME OPTIONS

- Hot dip galvanised mild steel

## FRAME FINISHES

- Galvanised
- Powdercoated

## INSTALLATION

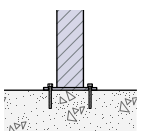

Bolt Down

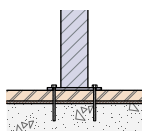

Bolt Through

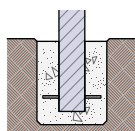

In Ground

## FIXINGS

- 12mm fixings for 14mm
- Diameter holes

Alternative materials and finishes available on request

# POD BENCH 1000

## SPECIFICATIONS

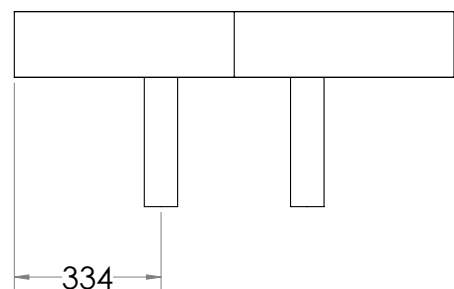
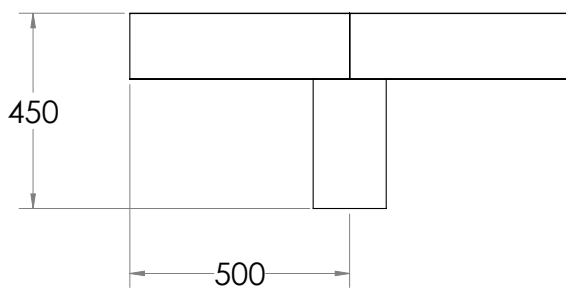
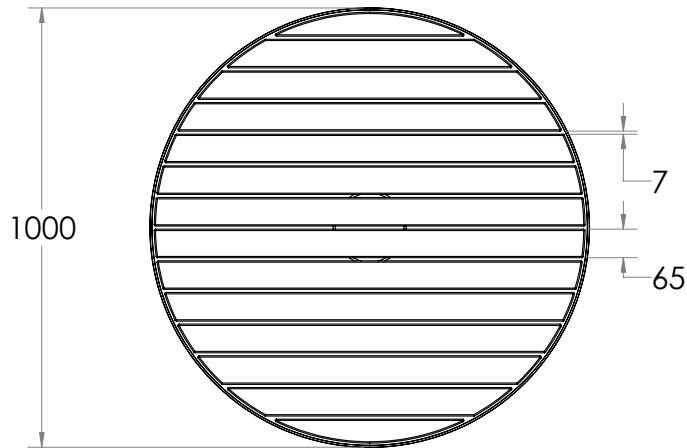

All measurements are in millimetres. Drawings are not to scale.  
Dimensions shown are for timber slat option

PRODUCT CODE	FRAME FINISH	SLAT OPTION & SIZE (mm)
<b>SINGLE LEG - IN GROUND</b>		
POD002-HDG-GV-T-1000-S	Galvanised	65 x 32 Oiled hardwood timber
POD002-HDG-GV-C-1000-S	Galvanised	60 x 40 Composite
POD002-HDG-PC-T-1000-S	Powdercoated	65 x 32 Oiled hardwood timber
POD002-HDG-PC-C-1000-S	Powdercoated	60 x 40 Composite
<b>FOUR LEGS - BASE PLATE</b>		
POD002-HDG-GV-T-1000-Q	Galvanised	65 x 32 Oiled hardwood timber
POD002-HDG-GV-C-1000-Q	Galvanised	60 x 40 Composite
POD002-HDG-PC-T-1000-Q	Powdercoated	65 x 32 Oiled hardwood timber
POD002-HDG-PC-C-1000-Q	Powdercoated	60 x 40 Composite

# POD BENCH 1200

## SPECIFICATIONS

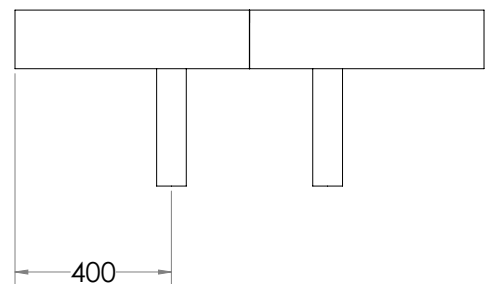
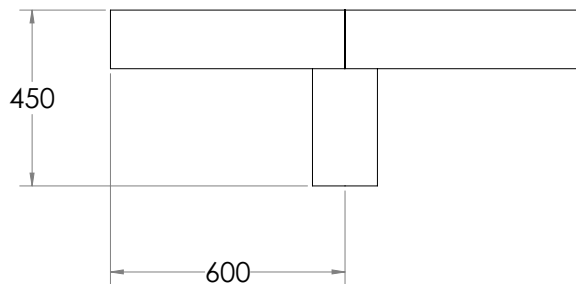
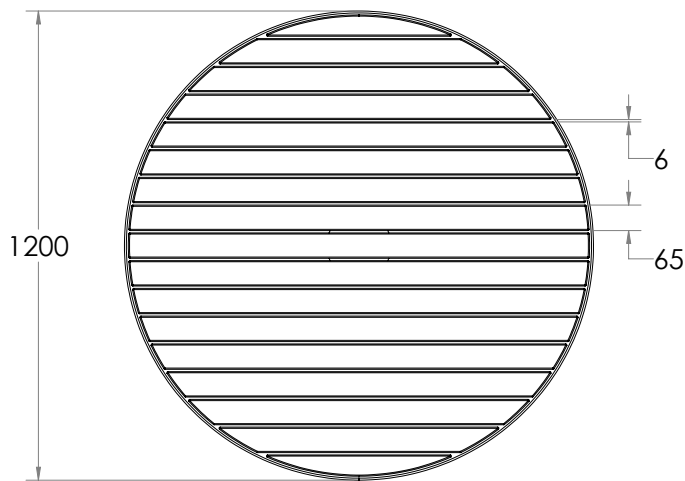

All measurements are in millimetres. Drawings are not to scale.  
Dimensions shown are for timber slat option

PRODUCT CODE	FRAME FINISH	SLAT OPTION & SIZE (mm)
<b>SINGLE LEG - IN GROUND</b>		
POD002-HDG-GV-T-1200-S	Galvanised	65 x 32 Oiled hardwood timber
POD002-HDG-GV-C-1200-S	Galvanised	60 x 40 Composite
POD002-HDG-PC-T-1200-S	Powdercoated	65 x 32 Oiled hardwood timber
POD002-HDG-PC-C-1200-S	Powdercoated	60 x 40 Composite
<b>FOUR LEGS - BASE PLATE</b>		
POD002-HDG-GV-T-1200-Q	Galvanised	65 x 32 Oiled hardwood timber
POD002-HDG-GV-C-1200-Q	Galvanised	60 x 40 Composite
POD002-HDG-PC-T-1200-Q	Powdercoated	65 x 32 Oiled hardwood timber
POD002-HDG-PC-C-1200-Q	Powdercoated	60 x 40 Composite

# POD BENCH 1500

## SPECIFICATIONS

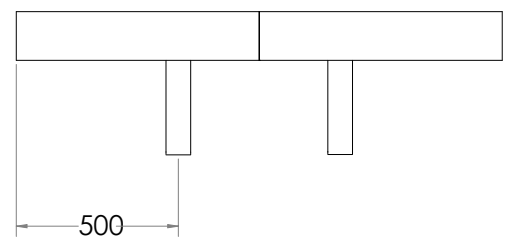
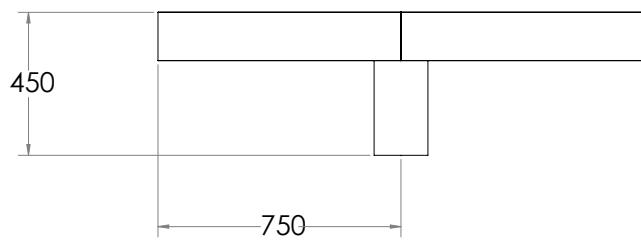
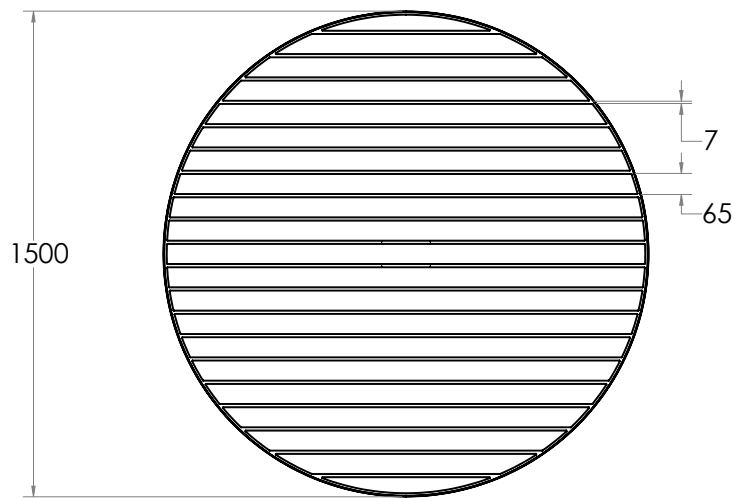

All measurements are in millimetres. Drawings are not to scale.  
Dimensions shown are for timber slat option

PRODUCT CODE	FRAME FINISH	SLAT OPTION & SIZE (mm)
<b>SINGLE LEG - IN GROUND</b>		
POD002-HDG-GV-T-1500-S	Galvanised	65 x 32 Oiled hardwood timber
POD002-HDG-GV-C-1500-S	Galvanised	60 x 40 Composite
POD002-HDG-PC-T-1500-S	Powdercoated	65 x 32 Oiled hardwood timber
POD002-HDG-PC-C-1500-S	Powdercoated	60 x 40 Composite
<b>FOUR LEGS - BASE PLATE</b>		
POD002-HDG-GV-T-1500-Q	Galvanised	65 x 32 Oiled hardwood timber
POD002-HDG-GV-C-1500-Q	Galvanised	60 x 40 Composite
POD002-HDG-PC-T-1500-Q	Powdercoated	65 x 32 Oiled hardwood timber
POD002-HDG-PC-C-1500-Q	Powdercoated	60 x 40 Composite

# POD BENCH 1800

## SPECIFICATIONS

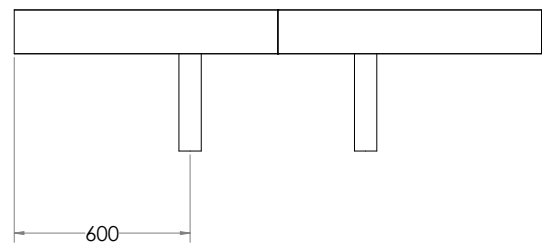
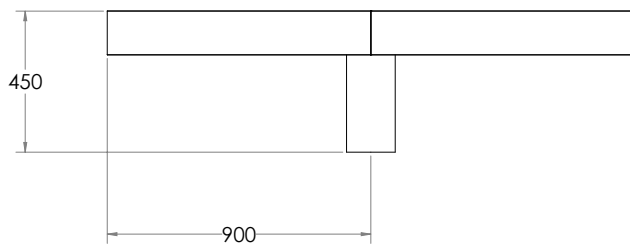
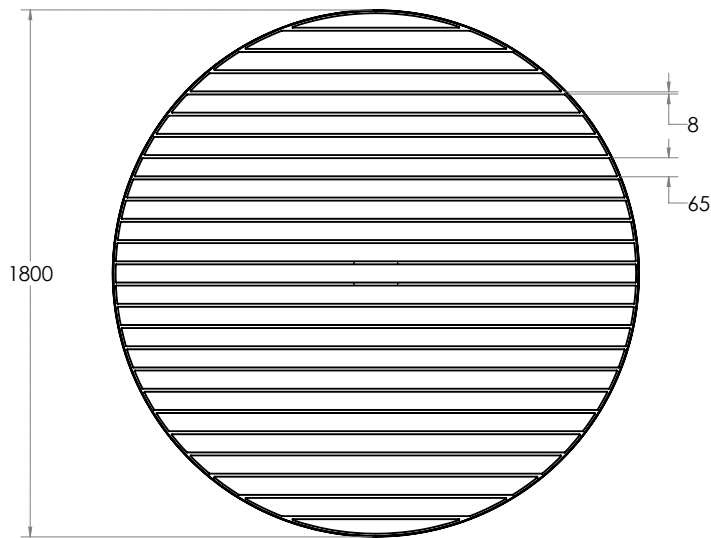

All measurements are in millimetres. Drawings are not to scale.  
Dimensions shown are for timber slat option

PRODUCT CODE	FRAME FINISH	SLAT OPTION & SIZE (mm)
<b>SINGLE LEG - IN GROUND</b>		
POD002-HDG-GV-T-1800-S	Galvanised	65 x 32 Oiled hardwood timber
POD002-HDG-GV-C-1800-S	Galvanised	60 x 40 Composite
POD002-HDG-PC-T-1800-S	Powdercoated	65 x 32 Oiled hardwood timber
POD002-HDG-PC-C-1800-S	Powdercoated	60 x 40 Composite
<b>FOUR LEGS - BASE PLATE</b>		
POD002-HDG-GV-T-1800-Q	Galvanised	65 x 32 Oiled hardwood timber
POD002-HDG-GV-C-1800-Q	Galvanised	60 x 40 Composite
POD002-HDG-PC-T-1800-Q	Powdercoated	65 x 32 Oiled hardwood timber
POD002-HDG-PC-C-1800-Q	Powdercoated	60 x 40 Composite